

## 19" SINGLE WALLMOUNT CABINET

WCAB 600X600

### DESCRIPTION

- Wirewin® 19" einteiliger Wandverteilerschrank
- Stahlrahmen
- Glastür mit Sicherheitsglas
- Farbe: RAL7035 grau
- 1 tiefenverstellbare 19 Zoll Ebene
- Material: 1,2mm Stahl
- Dachblech mit Kabeleinführungen und Öffnungen für Lüftereinheit
- Oberfläche (Türen, Seitenwände, Boden- und Dachabdeckung):
  - antistatische Pulverbeschichtung
- Verzinkte 19" Schienen
- RoHS kompatibel, UL und Gost-R zertifiziert
- Der Netzwerk-/Serverschrank wird fertig montiert geliefert
- Abmessungen:
  - Breite: 600mm
  - Tiefe: 600mm
  - Höhe: 9 HE / 12 HE / 16 HE / 20 HE
- Weitere Modelle auf Anfrage lieferbar

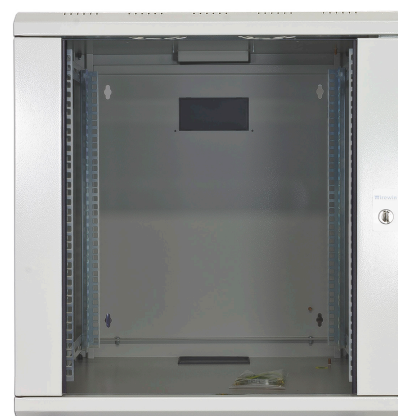

### Specifications:

Material:	<ul style="list-style-type: none"> <li>• Main Body (Structure): DIN EN 10130-DC-01-6112 CRS, 0,8 mm</li> <li>• Front Door: EN 12150-1 Tempered Secure Glas, 4,0 mm</li> <li>• 19" Equipment Mounting Rails: DIN EN 10130-DC-01-6112 CRS, 1,2 mm</li> <li>• Rear Body Frame: DIN EN 10130-DC-01-6112 CRS, 1,0 mm</li> <li>• Side Panels: DIN EN 10130-DC-01-6112 CRS, 0,8 mm</li> </ul>
Colour:	<ul style="list-style-type: none"> <li>• RAL7035, Light Grey or RAL9005 Black</li> </ul>
max. Load:	<ul style="list-style-type: none"> <li>• 100 kg load tested</li> </ul>
Packaging:	<ul style="list-style-type: none"> <li>• single, carton packaging, assembled</li> </ul>

### COLOUR: RAL7035, LIGHTGREY

UNITS	PART NUMBER	WIDTH	DEPTH	HEIGHT	WEIGHT	EAN NUMBER	P-WEIGHT	PACKING BOX SIZE
9U	WCAB 600X600X9U	600	600	505	22,0 kg	9120058270048	25,0 kg	650 x 650 x 550
12U	WCAB 600X600X12U	600	600	640	28,0 kg	9120117650583	31,0 kg	650 x 650 x 690
16U	WCAB 600X600X16U	600	600	818	36,0 kg		39,5 kg	650 x 650 x 870
20U	WCAB 600X600X20U	600	600	996	43,0 kg		46,5 kg	650 x 650 x 677

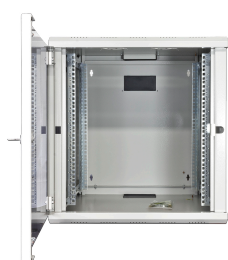

## 19" SINGLE WALLMOUNT CABINET

WCAB 600X600

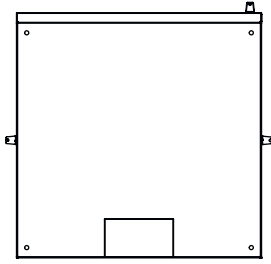

BOTTOM VIEW

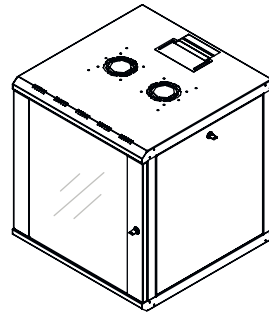

ISOMETRIC VIEW

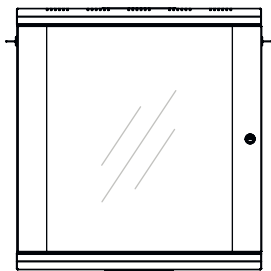

FRONT VIEW

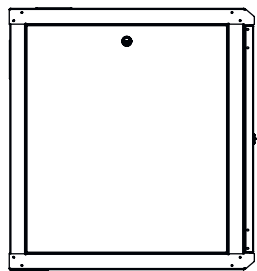

SIDE VIEW

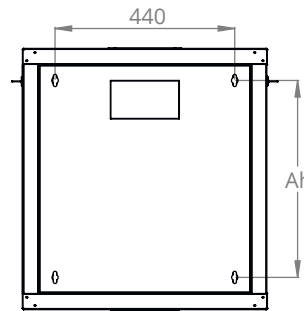

REAR VIEW

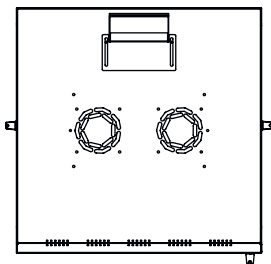

TOP VIEW

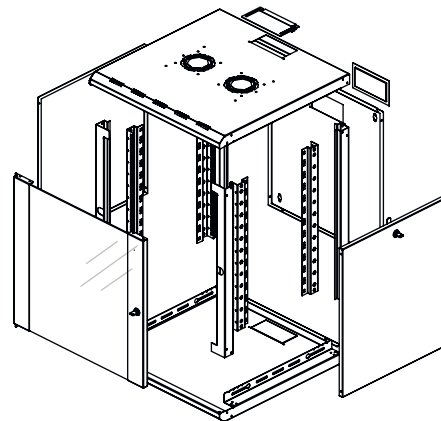

EXPLODED VIEW

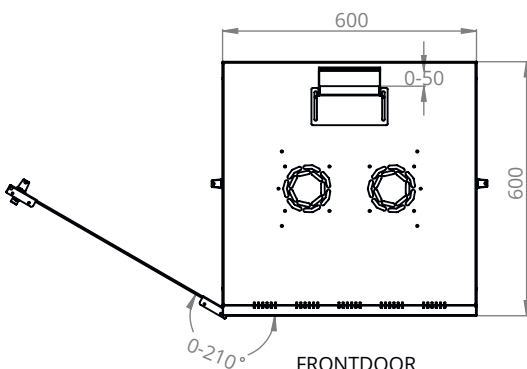

FRONTDOOR  
OPENING ANGLE

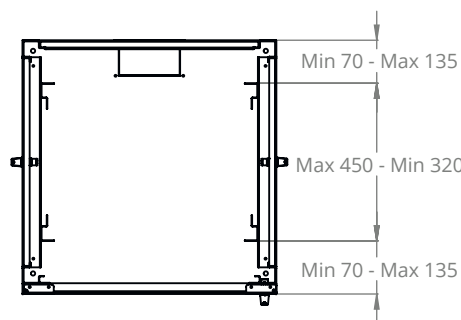

MAX / MIN EQUIPMENT  
MOUNTING DISTANCE

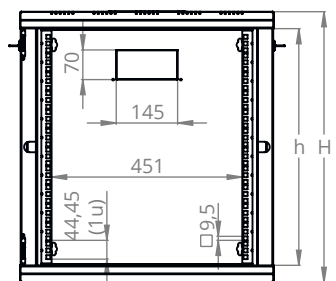

DIMENSIONS IN  
WIDTH AND HEIGHT

UNITS	Ah	h	H	D
9U	349	400	505	600 / 600
12U	482	533	640	600 / 600
16U	660	711	818	600 / 600
20U	838	889	996	600 / 600