

REVISIONS				
ZONE	REV	DESCRIPTION	DATE	DRAWN
	A			

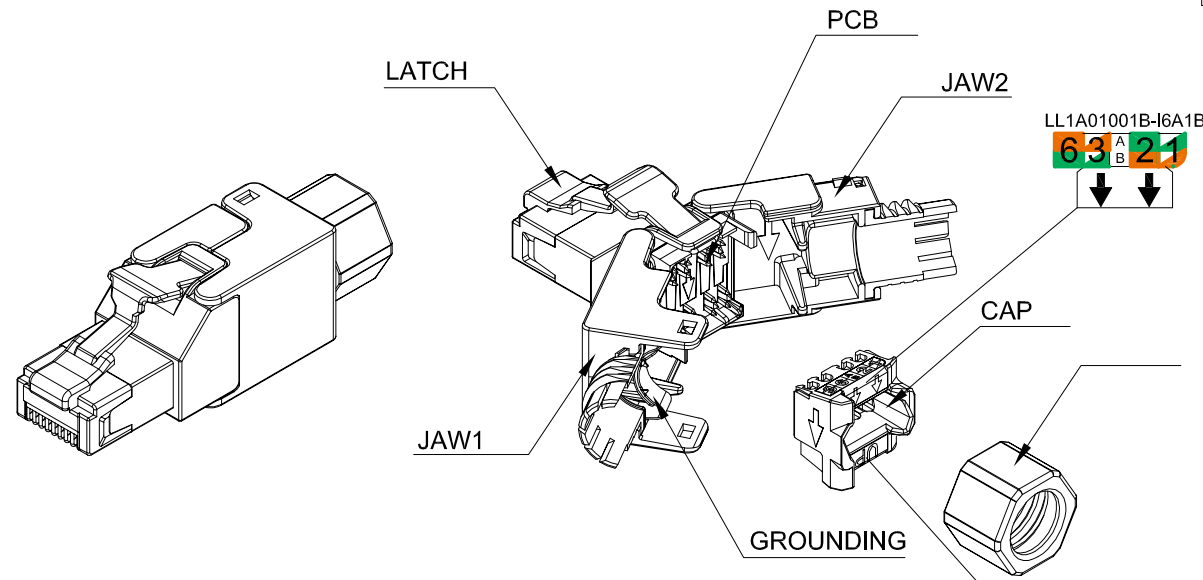

COMPONENTS			
ITEM	PART NAME	MATERIAL	Q'TY
1	PCB Module	_____	1
2	LATCH	PC 94V-0	1
3	JAW-1	Zinc-alloy	1
4	JAW-2	Zinc-alloy	1
5	GROUNDING	SUS304 CSP-1/2H	1
6	CAP	PC 94V-0	1
7	Nut	Copper	1
8	Wiring Lable-UP	Lable	1
9	Wiring Lable-DOWN	Lable	1

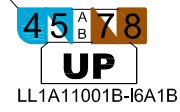
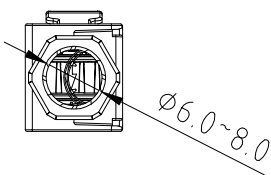
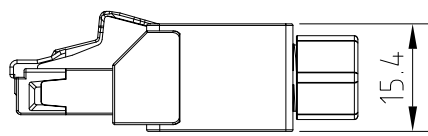
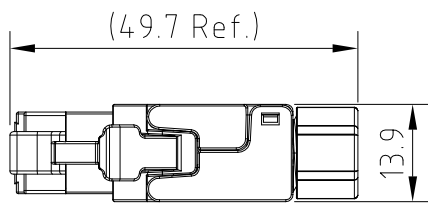

TRANSMISSION PERFORMANCE
 Meet all requirements specified in Patch Cord requirement of ISO/IEC 11801, Category 6A
 ANSI/TIA-568-C.2, Category 6A

ELECTRICAL
 Electrical Insulation Resistance : 500MΩ min. @100V d.c
 Dielectric Withstanding Voltage : 1000V D.C or A.C Peak,
 Contact to Contact;1500V D.C or A.C Peak,
 Contact to Shied@ 60Hz for 1 Minute.

MECHANICAL
 IDC Wire Gauge : 23 ~ 26 AWG

PHYSICAL
 Housing : Zinc-alloy fully shielded
 Contact pin : Phosphor Bronze Alloy Plated With 50 micro-inch of Gold
 IDC : Phosphor Bronze Alloy With 100 micro-inch 100% Sn Alloy

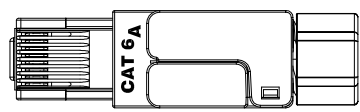
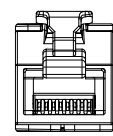

UNLESS OTHERWISE SPECIFIED: TOLERANCES		PROJECT ID	TITLE	
INCH .X ± .016 .XX ± .008 .XXX ± .004		FILE	DATE	WKS FK RJ45 KAT6A
MM .X ± 0.2 .XX ± 0.1 .XXX ± .5		DRAWN		 European Cabling Solutions
ANGULAR X ± 1' X ± .5'		CHECK		
MATERIAL		APPROVED		SIZE A4 DRAWING NUMBER WKS FK RJ45 KAT6A PART NUMBER WKS FK RJ45 KAT6A SCALE 1:1 UNIT mm SHEET 1 OF 1